

CK4A – ControlKeeper 4A

Catalog#	Prepared by
Project	Date
Comments	Type

Overview

The ControlKeeper 4A network lighting control panel is a cost-effective, specification grade lighting control system. Control up to 4 relays per panel with optional support for up to four 0-10V dimming ballast control outputs. Network up to 254 ControlKeeper panels for a state of the art lighting control system.

Features

- Support for up to four 0-10V dimming ballast outputs
- Electrically held normally open as well as mechanically latched and two pole relays available
- Capable of controlling receptacle loads
- 4 single pole or 2 two pole serial relays
- Open or closed loop control algorithms



Powering Business Worldwide

Specifications

Enclosure	NEMA 1 surface mount enclosure
Size	10" H x 14" W x 3.5" D
Transformer Ratings	Multi-tapped 120/277 VAC internally fused standard Optional 347 VAC internally fused Optional 220/230 VAC 50/60 Hz internally fused Optional 220/240 VAC 50/60 Hz internally fused
Power Use Ratings	Fully loaded panel 40 watts
Load Types	4-wire fluorescent loads, 0-10 VDC Isolated (40 μ A max per circuit leakage to line) Each 0-10V output supports up to 50 ballasts/drivers that draw the standard 2mA each
Operating Environment	Temperature: 32°F to 122°F (0°C to 50°C)
Master Override	ON/AUTO/OFF
Programming	Optional PC Software
Standard Relay Ratings	20A, 120/277 VAC Normally open Maximum wire size: 10 AWG Mechanical operations: 10 million
Latching Relay Ratings	20A, 120/277 VAC 15A, 347 VAC Maximum wire size: 6 AWG Mechanical operations: 10 million Provides a system SCCR rating of 10,000A
Two Pole Relay Ratings	20A, 208/240/480 VAC Normally open Maximum wire size: 6 AWG Mechanical operations: 10 million
Standards	UL Approval UL 916 Listed 

System Includes

- UL listed – UL 916 standard
- NEMA 1 enclosure
- 4 relays
- Support for 4 three-wire or 8 two-wire low voltage inputs
- 4 analog inputs
- Digital Switch interface
- Time schedules with astronomic clock
- Prioritization and masking of switch inputs, time schedules and remotes
- Timed inputs
- Occupant warn-off and overrides
- RS-232 port standard
- RS-485 network standard
- Open/Closed loop daylighting
- Control receptacle loads with Latching Relay Card

Accessories

- Keeper Enterprise Network Software
- Ethernet Interface Module
- Automation Interface Module
- CEPC (UL 924 Accessory)
- Greengate Digital Switch (GDS)
- Low Voltage Switches
- Contact Input or Analog Photocells
- Occupancy Sensor

Dimensions

Enclosure

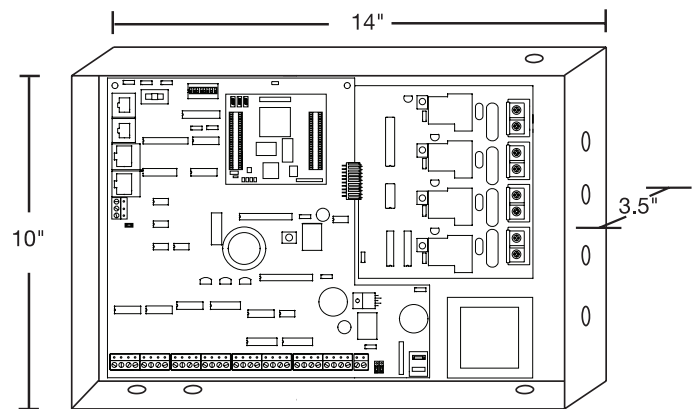

Wiring Diagram

Latching Relay Receptacle Control

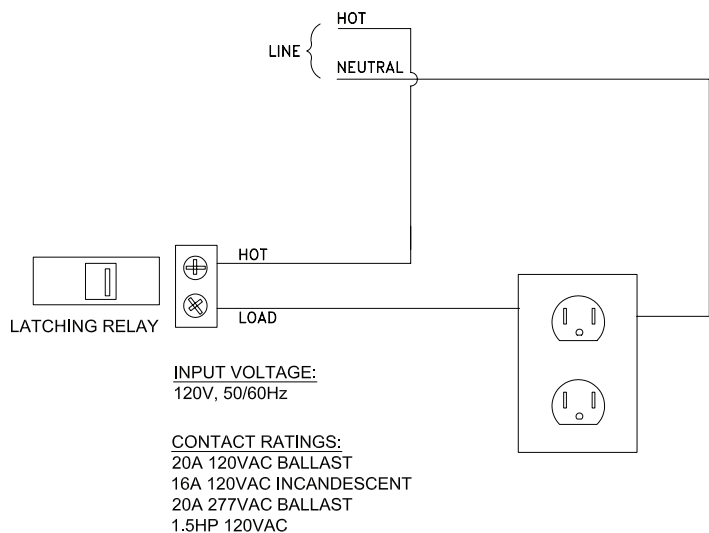

Reflective Ceiling Plan

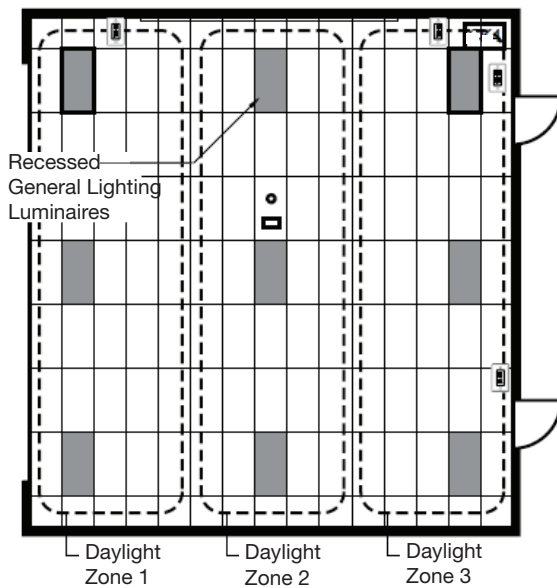

Sample Circuiting

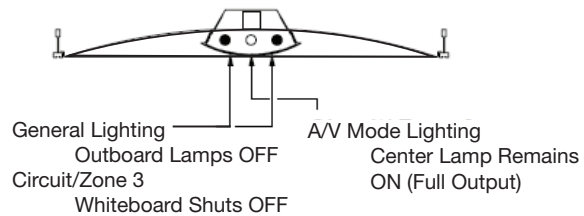

Sample Switch Control

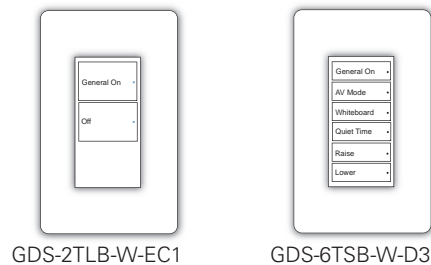

Sample One-Line

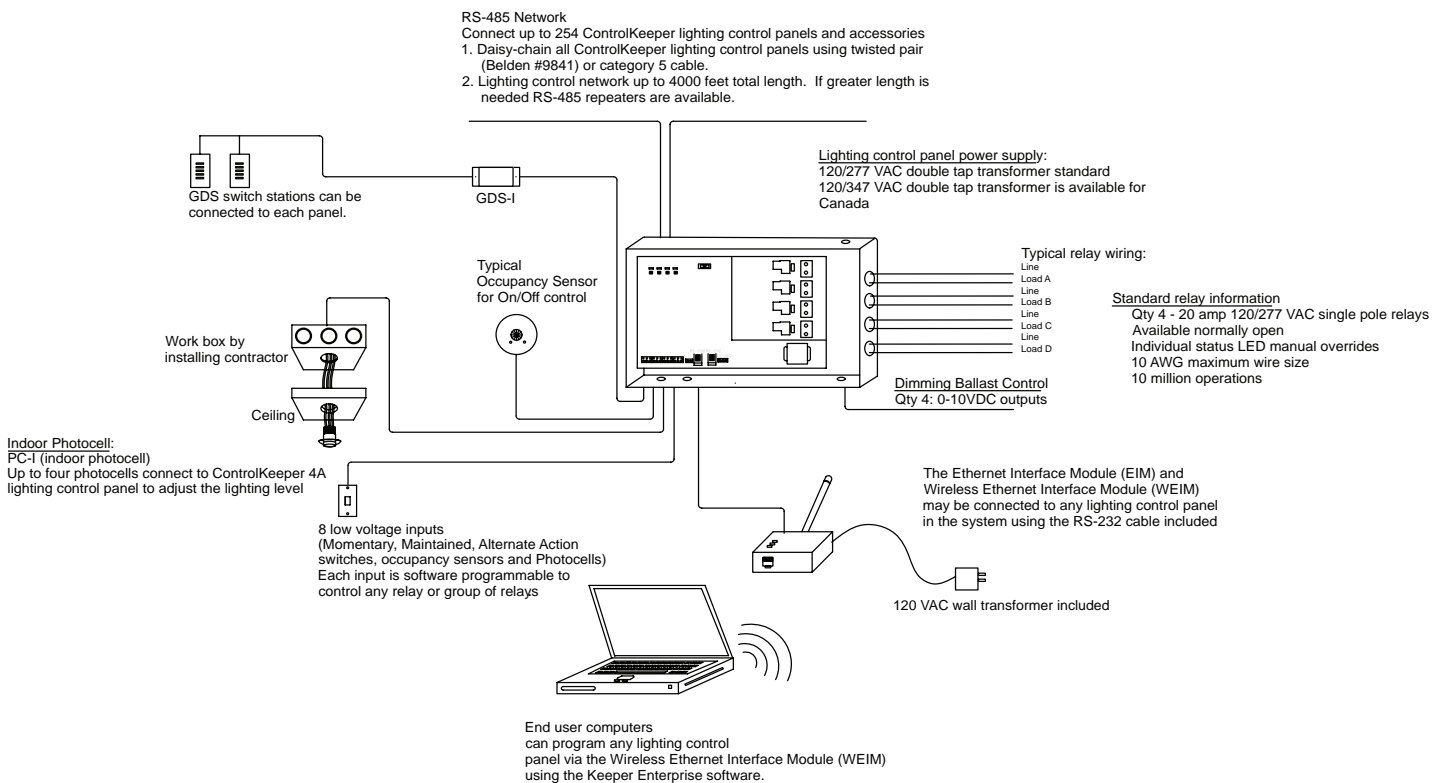

Ordering

This is a network-ready lighting control system. It can be combined with other ControlKeeper series panels to create a scalable, networked lighting control scheme. It can be ordered with any suitable system option or accessory.

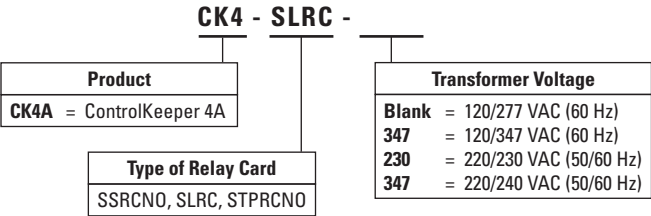

Eaton
1000 Eaton Boulevard
Cleveland, OH 44122
United States
Eaton.com

Eaton
Lighting systems
203 Cooper Circle
Peachtree City, GA 30269
www.eaton.com/lightingsystems

© 2015 Eaton
All Rights Reserved
Printed in USA
Publication No. TD503047EN
September 4, 2015

Eaton is a registered trademark.

All other trademarks are property
of their respective owners.

